

RIGHT OF WAY EXHIBIT

LOTS 1, 2, AND 5, MERCIER BLUFF
AND LOTS 3-4 AND 4-A, REPLAT OF LOTS 3 AND
4, MERCIER BLUFF

A SUBDIVISION IN KANSAS CITY, JACKSON COUNTY, MISSOURI.



- LEGEND:
- POWER POLE
 - OVERHEAD UTILITY LINES
 - SANITARY SEWER LINE
 - WATER LINE
 - OHP
 - SS
 - W

SET 1/2" REBAR WITH PLASTIC CAP STAMPED "LS-2007000089"
SET 5/8" REBAR WITH PLASTIC CAP STAMPED "LS-2007000089"
SET "x" CUT IN CONCRETE
FOUND 1/2" MONUMENT AS NOTED
FOUND 5/8" MONUMENT AS NOTED
FOUND "x" CUT IN CONCRETE
(M) MEASURED BEARING OR DISTANCE
(P) PLATTED BEARING OR DISTANCE
(D) IF VALUE IS NOT LABELED IT IS MEASURED (BETWEEN MONUMENTS)
OR CALCULATED BASED ON MEASUREMENTS TO MONUMENTS

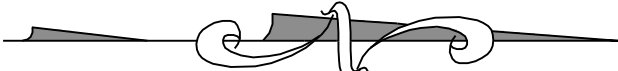
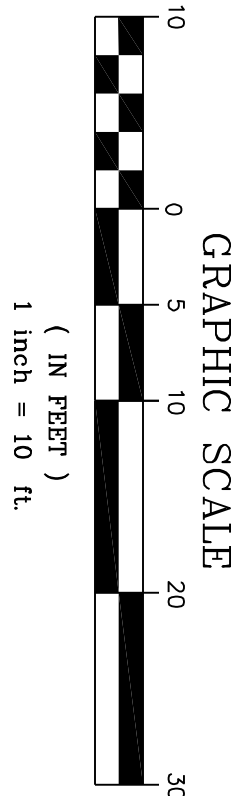

OWNER/DEVELOPER:
ROTHERS INC.
5309 NW BLUFF DRIVE
PARKVILLE, MO 64152

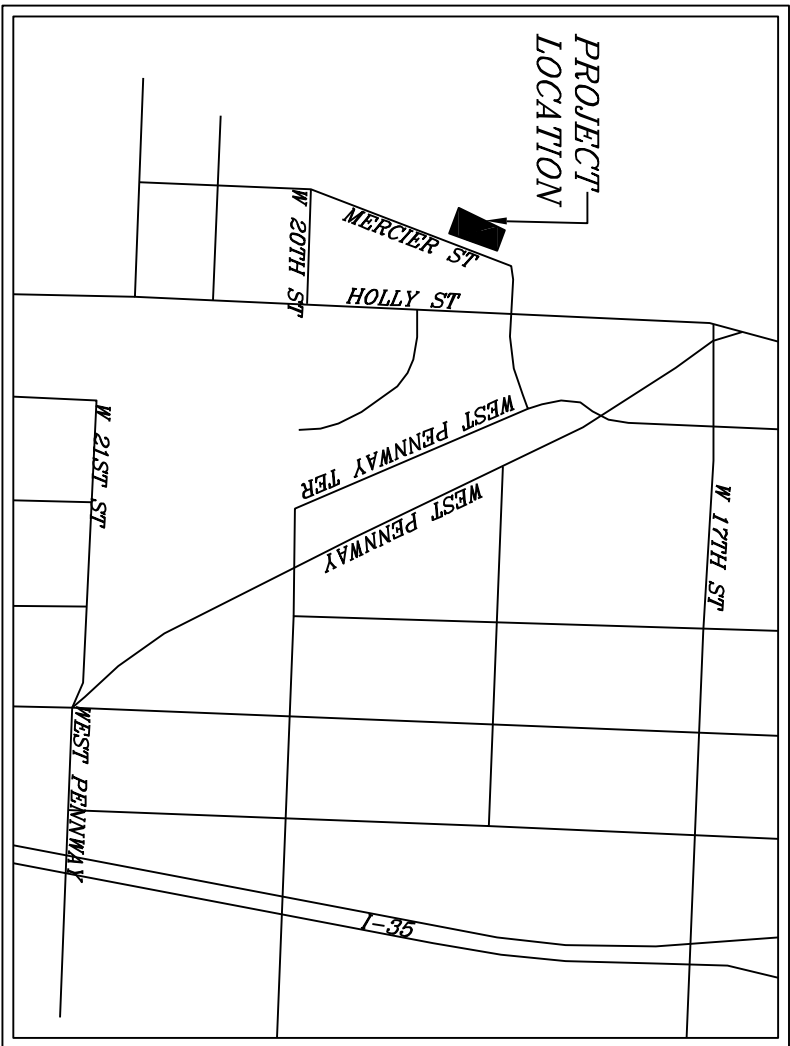

© COPYRIGHT 2024 R.L. BUFORD & ASSOCIATES, LLC
E:\A-JACKSON COUNTY\J-24465 ROTHERS MERCIER STEPS\dwg\J-24465 7 FOOT OPTION.dwg 12/12/2024 12:11:44 PM CST

R.L. Buford & Associates, LLC
LAND SURVEYING - DEVELOPMENT CONSULTANTS
R.L. BUFORD & ASSOCIATES, LLC - MO CERT. OF
AUTHORITY LICENSE NO. LS-2010031977
rob@rlbuford.com

P.O. BOX 14069, PARKVILLE, MO, 64152 (816) 741-6152

| | | | |
|--|---|---------------------------------|--------------------|
| FOR ROTHERS INC. 5309 NW BLUFF DRIVE PARKVILLE, MO 64152 | SEC.-TWP.-RGE. 7-49-33 DATE 12/11/2024 | COUNTY JACKSON FIELD BOOK | JOB NO. J-24465 |
| RIGHT OF WAY EXHIBIT | | | DRAWN BY R.C.Y. |