

CD-CPC-2025-00128

Text Amendments: Digital Signs in Residential Districts

August 20, 2025

City Plan Commission



Section 88-445-06: Signs in Residential Districts

4. Institutional and Office Uses (church, school, police or fire station, community center, public park, office building, other permitted principal use)

Monument signs

Wall Signs

Incidental Signs

Interim Signs

Proposed Text Amendment

- New Section 88-445-06-A 4. (e) – Digital Signs
- Requirements:
 - Special Use Permit
 - Lot at least 6 acres in size OR lot at least 3 acres in size adjacent to a major arterial street
 - Digital sign face on one monument sign

Additional Requirements (Location):

1. At least 100 feet from any other residentially zoned and occupied property and must be setback at least 100 feet from any public right-of-way.
2. Not be located within 150 feet of a public park or a parkway or boulevard.
3. Not be located on a lot that is within a designated historic district or on a lot where there exists a designated historic landmark.

Additional Requirements (Operations):

4. May not change more than once every hour.
5. Changes of image must be instantaneous (no effects)
6. Automatic light level controls
7. Not illuminated between 10pm and 7am
8. Background may not be white
9. Sign must be turned off if malfunctioning

Staff recommendation

Approval

2015

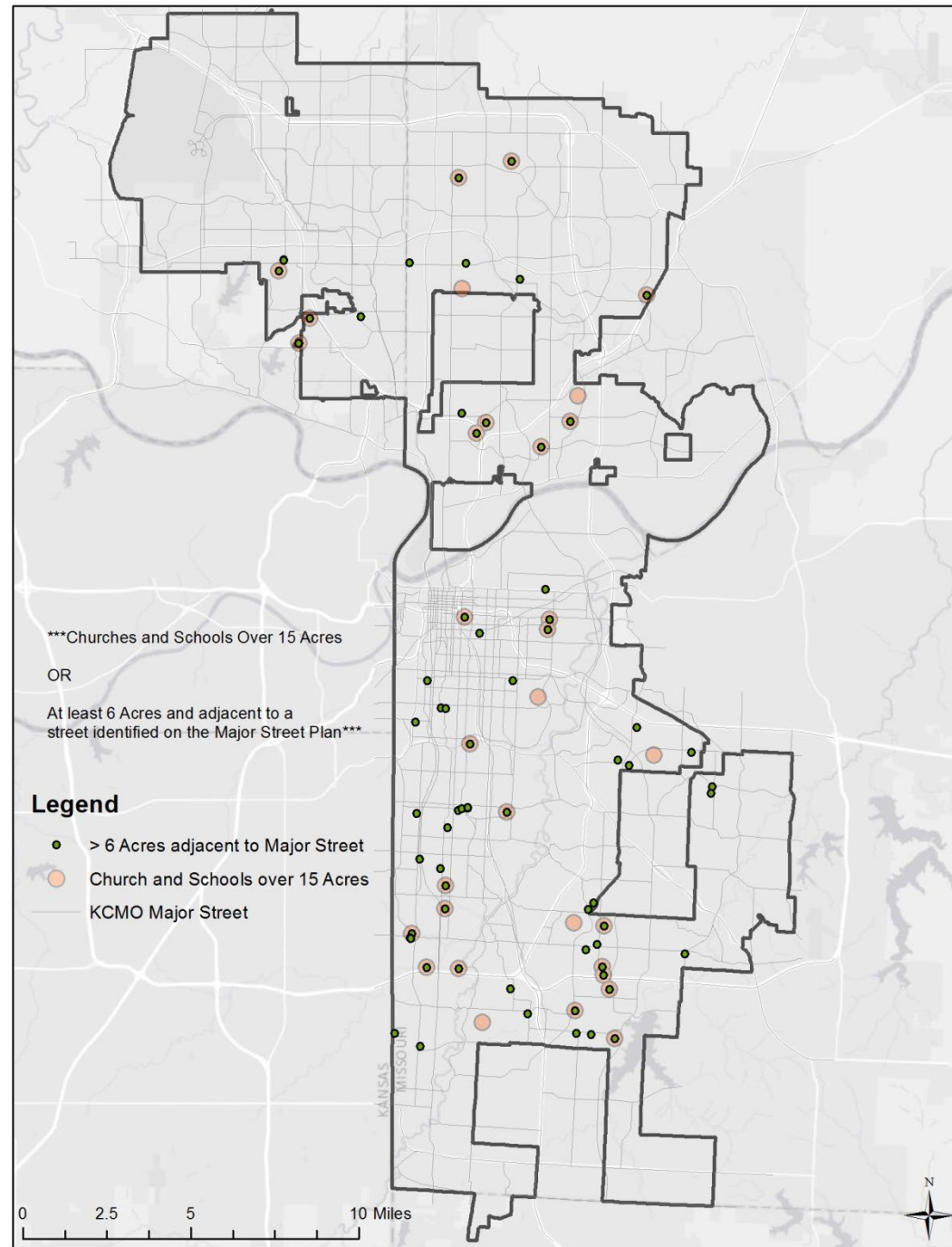

Lot at least 6 acres in size OR lot at least 3 acres in size adjacent to a major arterial street

- Lakewood Elementary, NKC
 - 6.96 acres

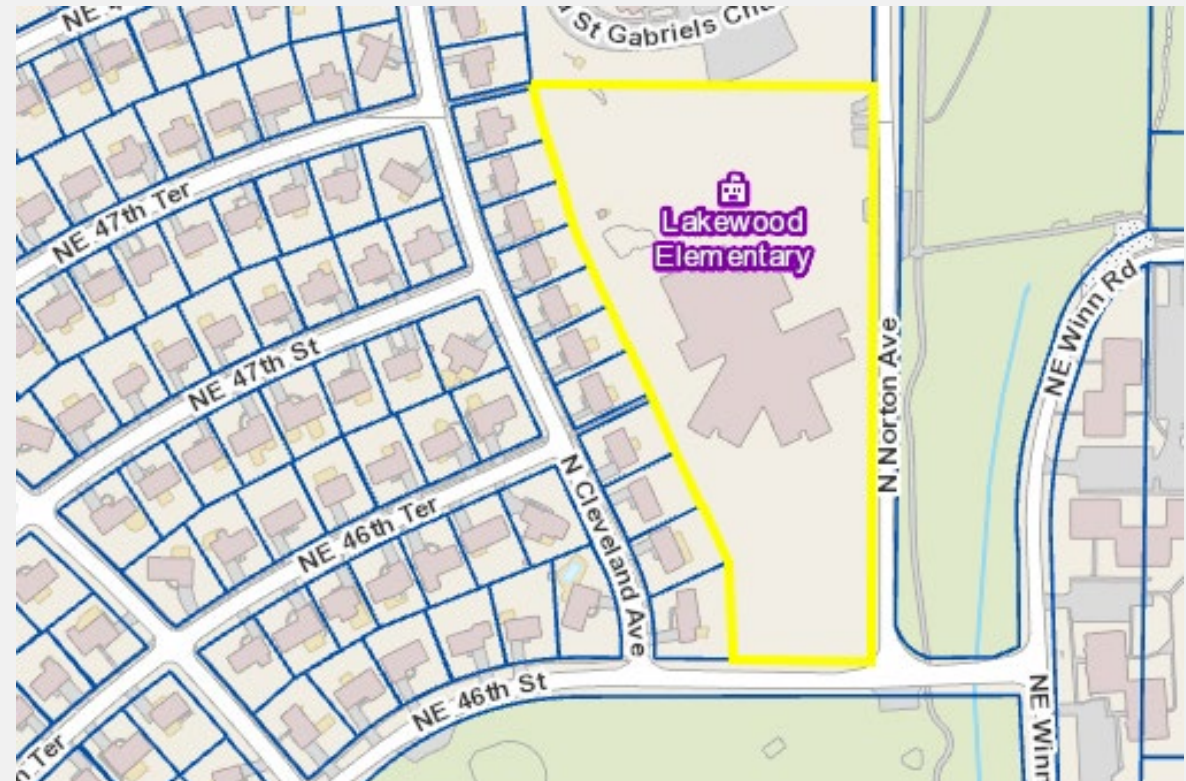

Lot at least 6 acres in size OR lot at least 3 acres in size adjacent to a major arterial street

- Gashland Elementary, NKC
 - 3.05 acres
 - Barry Road

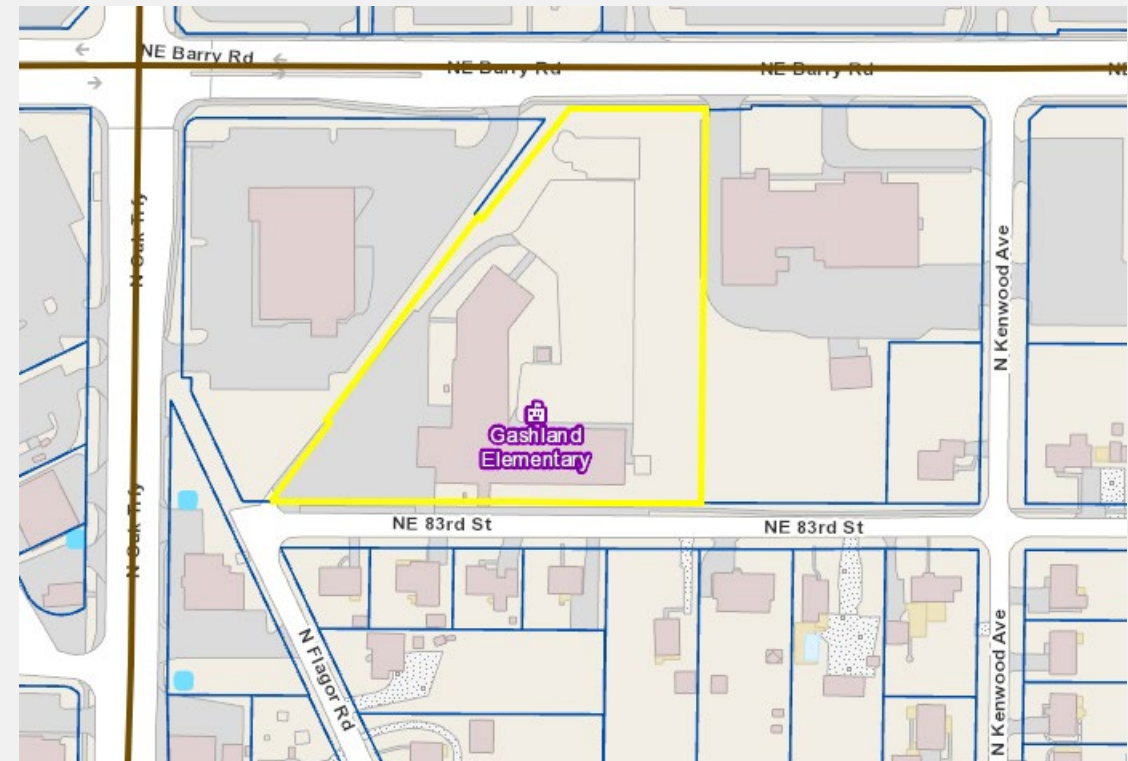

Lot at least 6 acres in size OR lot at least 3 acres in size adjacent to a major arterial street

- Academie Lafayette
 - 3.77 acres
 - Not on an arterial street

