

Docket #3.1 & 3.2

Case No. CD-CPC-2022-00087

3600 Walnut Street
The Walnut Townhomes

Rezoning to MPD
Development Plan (Residential) & Preliminary Plat

Case No. CD-CPC-2022-00085

Area Plan Amendment



Case No. CD-CPC-2022-00085 & CD-CPC-2022-00087

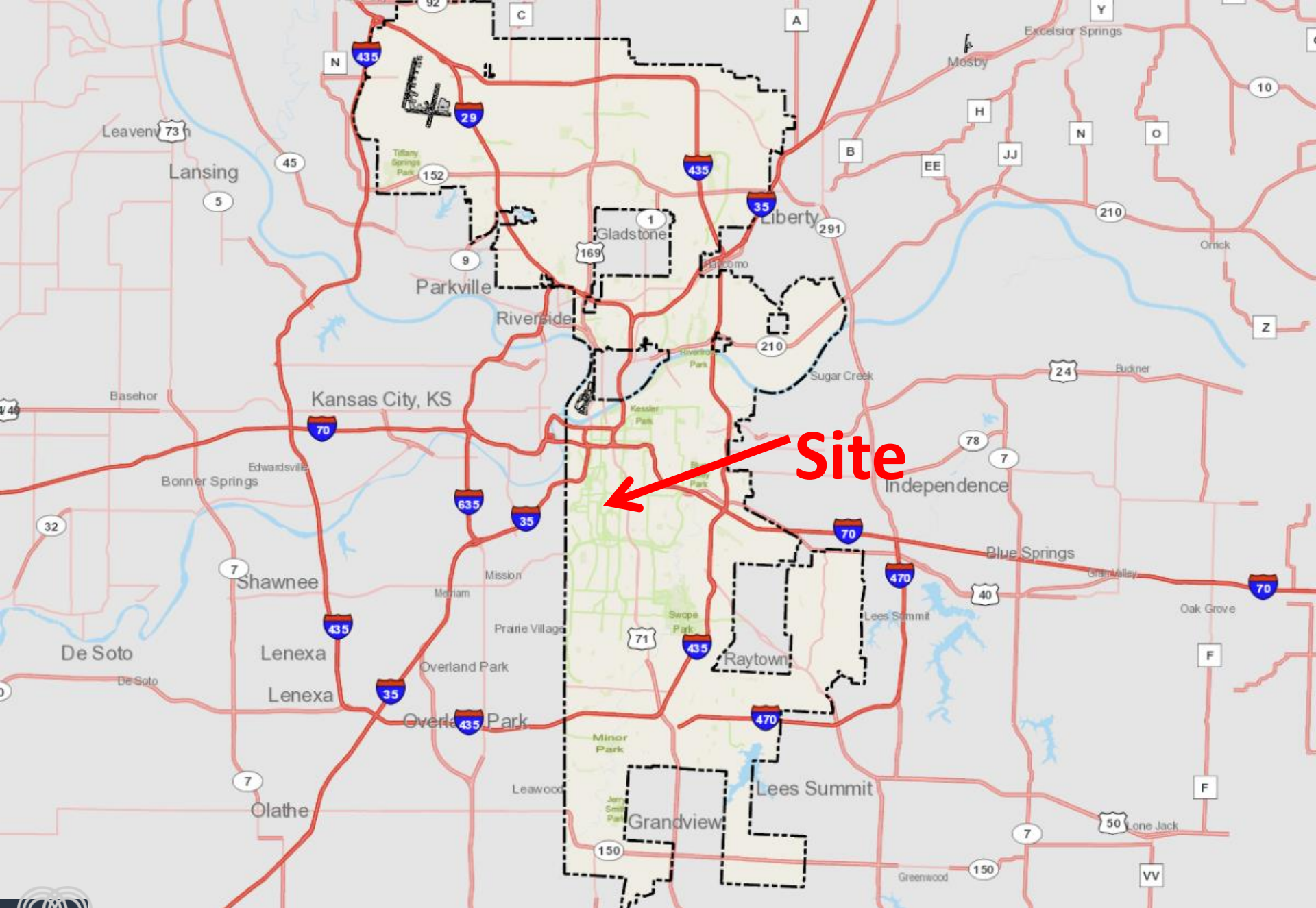

Site



View looking southwest from Walnut Street



Case No. CD-CPC-2022-00085 & CD-CPC-2022-00087

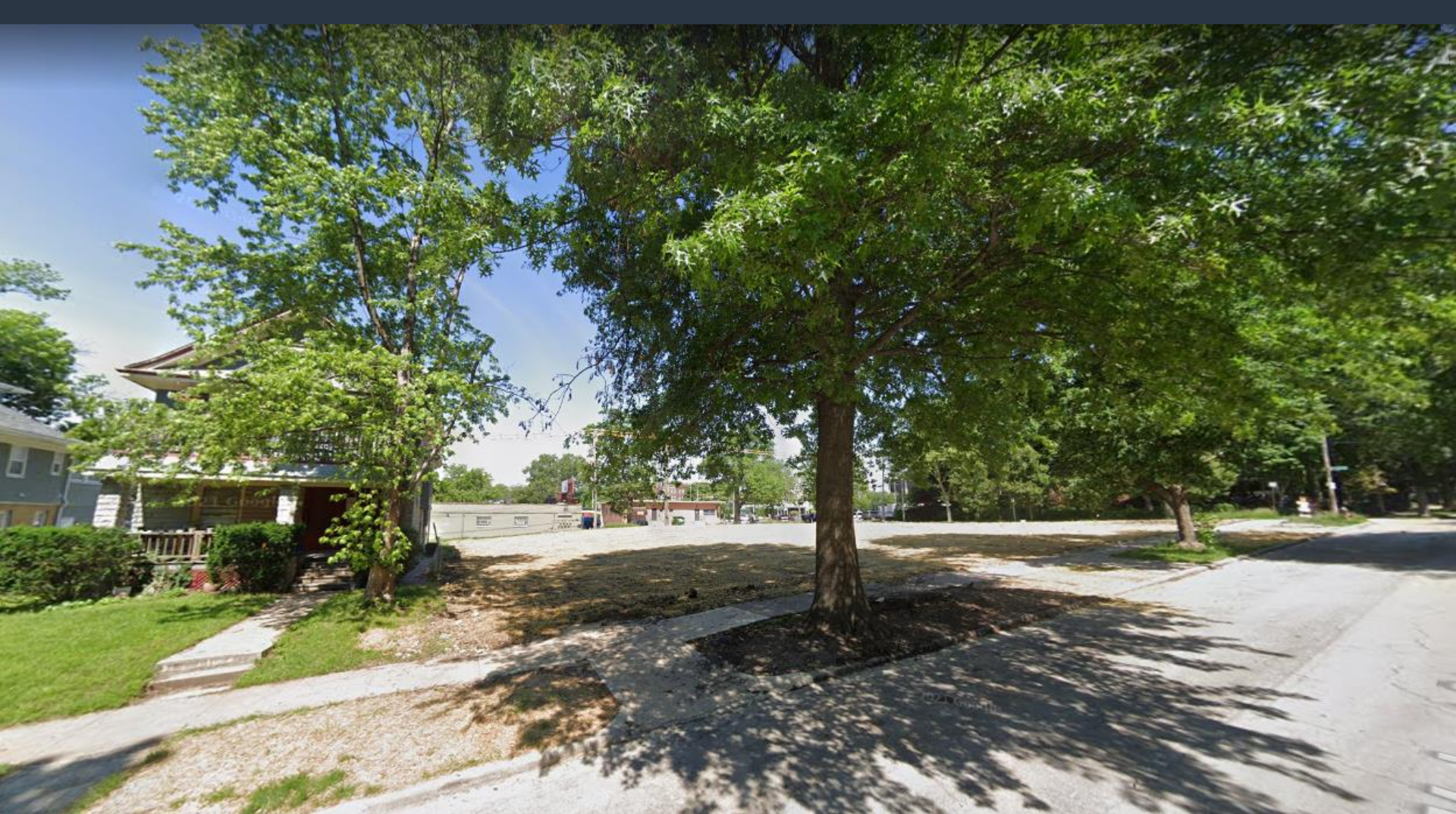

View looking west from Walnut Street



Case No. CD-CPC-2022-00085 & CD-CPC-2022-00087



View looking east from E. 36th Street



Case No. CD-CPC-2022-00085 & CD-CPC-2022-00087



East Elevation



Case No. CD-CPC-2022-00085 & CD-CPC-2022-00087



West Elevation



5 EAST 36th Street END OF UNITS ELEVATIONS (SIMILAR AND MIRRORED)
3/32" = 1'-0"



4 EAST 36th Street SOUTH ELEVATIONS
3/32" = 1'-0"



3 EAST 36th Street NORTH ELEVATIONS
3/32" = 1'-0"

36th Street Elevations



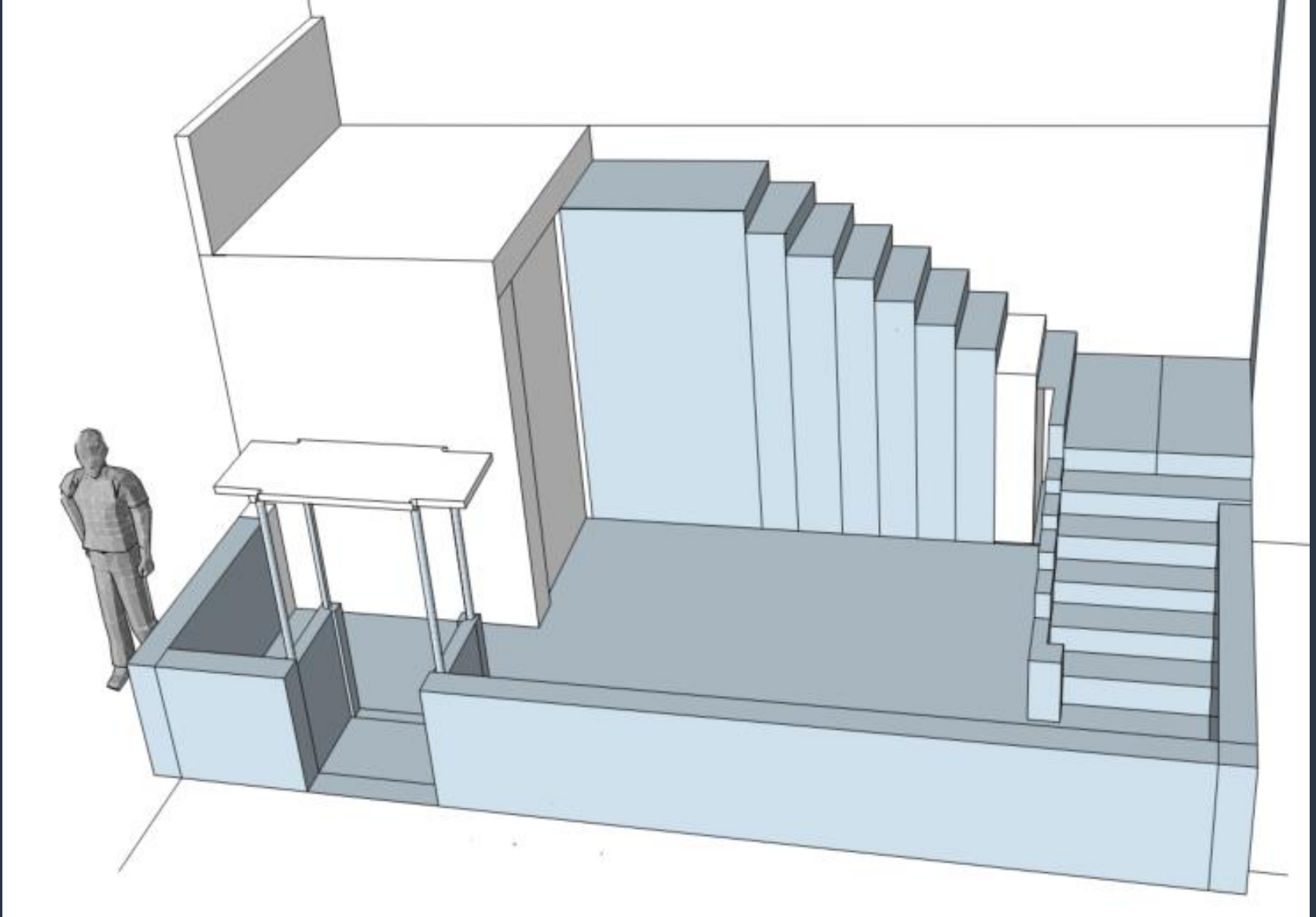

Porch Example



Case No. CD-CPC-2022-00085 & CD-CPC-2022-00087

Staff Recommendation:

Case No. CD-CPC-2022-00085

Approval without Conditions

Case No. CD-CPC-2022-00087

Approval with Conditions