

Docket Item #8

CD-CPC-2025-00035

Development Plan (Residential)

Linwood and Main Apartments – 20 W Linwood Blvd

May 7, 2025

Prepared for

City Plan commission







Landscape Plan

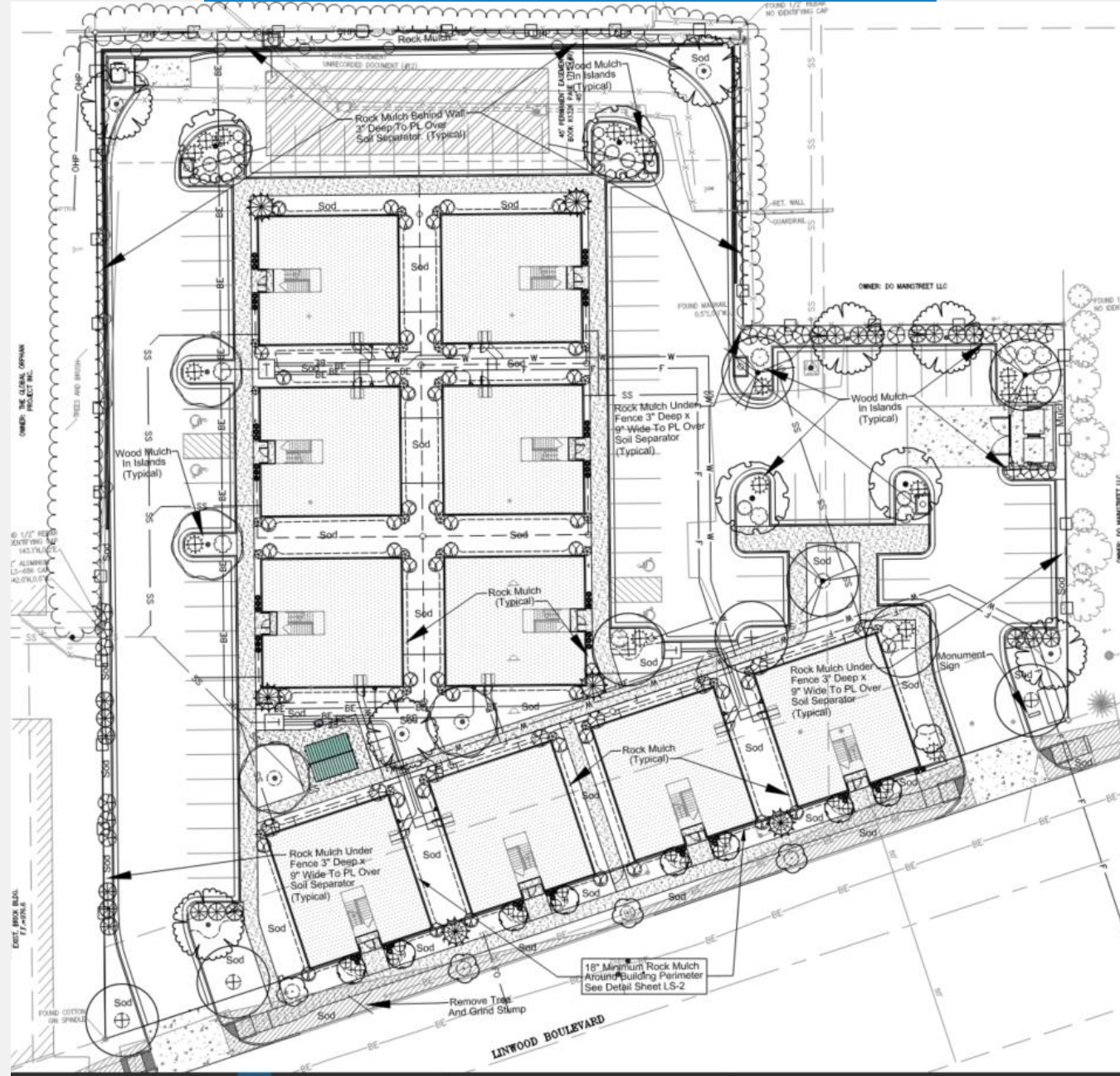





3 SIDE ELEVATION
1/4" = 1'-0"

MATERIAL LEGEND	
COLOR 1	SW 7063 - NEBULOUS WHITE
COLOR 2	SW 7599 - TIKI HUT
COLOR 3	SW 7069 - IRON ORE
BRICK VENEER	WHITE
STANDING SEAM	BLACK
PARAPET CAP	BLACK

TRANSPARENCY CALCULATIONS	
MAIN STREET	FRONT ELEVATION
1st FLOOR	AREA 250 WINDOW 113 45%
2nd FLOOR	AREA 247 WINDOW 108 44%
3rd FLOOR	AREA 247 WINDOW 108 44%



2 BACK ELEVATION
1/4" = 1'-0"



Looking west on Linwood Blvd (subject site on right). (June 2024)



Looking towards on W Linwood Blvd & Baltimore Ave. (June 2024)

Staff Recommendation

Case No. CD-CPC-2025-00035

Approval with Conditions